

CYGNUSTM

Variable White

LED Luminaires
200W Model 6520
100W Model 7520



Table of Contents

Declaration of Conformity	5
Safety Notice	6
Introduction	16
Quick Start (for DMX control)	17
Quick Start (for Grip Mode)	18
Cygnus Operation	19
Selecting Normal or Grip Mode.....	19
Video (High Speed) Mode	19
Color Temperature.....	19
Fan Speed	19
Normal (DMX) Mode	20
Grip (local) Mode.....	20
Fixture Physical Setup	21
Mounting and Adjusting Fixture	21
Connecting AC Power.....	21
Changing the Lenses	22
User Interface	24
Controls and Indicators	24
Menu Tree (Normal Mode)	26
Display Messages.....	27
DMX Channel Assignments	28
RDM Functionality	28
Flash Reprogramming	29
Cygnus Specifications	29

Appendix A - Color Temperature Table	34
Appendix B - Photometrics	35
Warranty Information	37

Document Version

(V1.2) This document applies to Cygnus software V1.3 and higher.

Declaration of Conformity

Manufacturer Name: Wybron, Inc.

Manufacturer Address: 4830 List Drive, Colorado Springs, CO 80919

Equipment Name: Cygnus VNS100, VNS200, MFS200, VW100, VW200 LED
Luminaire

Equipment Model: 6500, 6501, 7500, 6520, 7520

This product is in conformity with the following standards:

Referenced Safety Standards

EN60598 – 1
EN60598 – 2 – 17

Referenced EMC Standards

EN55022
EN61000-6-3

following the provisions of the EU LV Directive 73/23/EEC and the EU EMC
Directive 89/336/EEC

I declare that the equipment specified above conforms to the above Directive(s)
and Standard(s).

Signature:

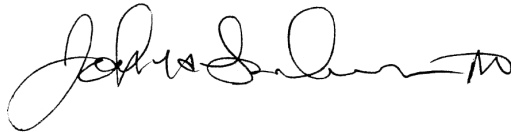

January 7, 2010

John Sondericker III

Vice President, Research and Development

Safety Notice

SAVE THESE INSTRUCTIONS READ AND FOLLOW ALL INSTRUCTIONS

- ❖ This manual gives step-by-step instructions for preparation, setup, and operation of the Cygnus LED luminaire.
- ❖ There is a potential risk of fire, electric shock or injury to persons if the product is not used as instructed.
- ❖ The Cygnus is to be used in an indoor environment only.

Product Modification Warning

Wybron, Inc. products are designed and manufactured to meet the requirements of United States and International safety standards. Modifications to the products could affect safety and render the product non-compliant to relevant safety standards.

Important Safety Instructions

Read this manual before powering or installing the fixture. Follow the safety precautions and observe all warnings in this manual and on the fixture. If you have questions about how to operate the fixture safely, please contact your Wybron dealer or call Wybron directly at 1-800-624-0146, or go to www.wybron.com.

To protect yourself and others from electric shock:

WARNING – THIS EQUIPMENT MUST BE EARTHED.

- ⚡ Protection against electric shock is assured only if the mains connected cord set is connected to a properly earthed grounding type receptacle.
- ⚡ Use a good source of AC power that complies with local building and electrical codes and has both overload and ground fault protection.
- ⚠ IP20 rating. Suitable for dry locations only. Do not expose the fixture to rain or moisture.
- ⚠ Refer all service to a Wybron certified service technician.

To protect yourself and others from burns and fire:

- ⚠ Maximum ambient temperature, $T_a=40^{\circ}\text{C}$ (104°F)
- ⚠ Provide a minimum clearance of 10 cm (4 inches) around all air vents.
- ⚠ Do not modify the fixture or install any parts other than genuine Wybron replacement parts.

To protect yourself and others from injury due to falls:

- △ When suspending the fixture above ground level, verify that the structure can hold at least 10 times the weight of all installed devices.
- △ Verify that all external accessories and rigging hardware are securely fastened and use an approved means of secondary attachment such as a safety cable.
- △ Block access below the work area whenever installing or removing the fixture.

Safety Notice (French Translation)

CONSERVER CES INSTRUCTIONS

LIRE ET SUIVRE TOUTES LES INSTRUCTIONS

- ❖ Ce manuel donne des instructions étape-par-étape pour la préparation, l'installation et le fonctionnement du CygnusLED luminaire.
- ❖ Il ya un risque potentiel d'incendie, d'électrocution ou de blessures si le produit n'est pas utilisé selon les instructions.
- ❖ Le Cygnus TM doit être utilisé dans un environnement intérieur.

Attention modification du produit

WYBRON, Inc produits sont conçus et fabriqués pour répondre aux exigences des États-Unis et les normes de sécurité internationale. Modifications aux produits pouvant affecter la sécurité et rendre le produit non-conforme aux normes de sécurité applicables.

Consignes de sécurité importantes

Lisez ce manuel avant de mettre ou d'installer l'appareil. Suivez les consignes de sécurité et respecter tous les avertissements dans ce manuel et sur le gabarit. Si vous avez des questions sur comment faire fonctionner le dispositif en toute sécurité, s'il vous plaît contacter votre revendeur ou appelez WYBRON WYBRON directement au 1-800-624-0146, ou visitez le www.wybron.com.

Pour vous protéger, vous et d'autres contre les chocs électriques:

AVERTISSEMENT - CET APPAREIL DOIT ETRE MIS A LA TERRE.

⚡ Protection contre les chocs électriques est assurée uniquement si le réseau connecté cordon est branché à un terre mise à la terre prise de courant.

⚡ Utiliser une bonne source de courant alternatif qui est conforme aux codes de construction locaux et électriques et a la fois protection de surcharge et de fuite de terre.

Note IP20

⚠. Convient aux endroits secs seulement. Ne pas exposer l'appareil à la pluie ou l'humidité.

⚠ Voir tous les services d'un technicien de service certifié WYBRON.

Pour vous protéger et protéger les autres de brûlures et d'incendie:

⚠ maximum la température ambiante, $T_a = 40\text{ }^{\circ}\text{C}$ ($104\text{ }^{\circ}\text{F}$)

⚠ Fournir un dégagement minimum de 10 cm (4 po) autour de toutes les bouches d'aération.

⚠ Ne pas modifier le dispositif ou d'installer des pièces autres que des pièces de rechange WYBRON.

Pour vous protéger, vous et d'autres contre les blessures dues aux chutes:

- △ Si on suspend le montage ci-dessus du niveau du sol, vérifier que la structure peut contenir au moins 10 fois le poids de tous les périphériques installés. Vérifiez
- △ que tous les accessoires externes et matériel de calage sont solidement attachés et utiliser un approuvé des moyens de fixation secondaire, tel qu'un câble de sécurité.
- △ Interdisez l'accès sous la zone de travail pendant l'installation ou le retrait du dispositif.

Safety Notice (Spanish Translation)

GUARDE ESTAS INSTRUCCIONES LEA Y SIGA TODAS LAS INSTRUCCIONES

- ❖ Este manual da instrucciones paso por paso para la preparación, instalación y funcionamiento de la luminaria LED™ Cygnus.
- ❖ No es un riesgo potencial de incendio, choque eléctrico o lesiones a las personas si el producto no se utiliza según las instrucciones.
- ❖ El Cisne™ se va a utilizar en un ambiente exclusivo en interiores.

Advertencia La modificación del producto

Wybron, Inc. Los productos están diseñados y fabricados para satisfacer las necesidades de los Estados Unidos y las normas internacionales de seguridad. Modificaciones en los productos podría afectar a la seguridad y hacer que el producto no conforme a las normas de seguridad pertinentes.

Instrucciones de seguridad importantes

Lea este manual antes de encender o instalar el aparato. Siga las precauciones de seguridad y observar todas las advertencias en este manual y en el aparato. Si usted tiene preguntas acerca de cómo operar el equipo con seguridad, por favor, contacte con su distribuidor o llame al Wybron Wybron directamente en 1-800-624-0146, o vaya a www.wybron.com.

Para protegerse a sí mismo ya los demás de una descarga eléctrica:

ADVERTENCIA - ESTE EQUIPO DEBE SER CONECTADO A TIERRA.

- ⚡ Protección contra choques eléctricos está garantizada sólo si el conjunto de cables de red conectados está conectado a un tomacorriente debidamente conectado a tierra tipo.
- ⚡ Utilice una buena fuente de alimentación de CA que cumpla con los códigos locales de construcción y eléctricos y tiene protección contra sobrecarga y falla a tierra.
- ⚠ Clasificación IP20. Apto para lugares secos. No exponer el aparato a la lluvia o la humedad.
- ⚠ Consulte todos los servicios de un técnico de servicio Wybron certificado.

Para protegerse y proteger a otros de las quemaduras y fuego:

- ⚠ Máxima temperatura ambiente, Ta = 40 °C (104 °F)
- ⚠ Dejar una distancia mínima de 10 cm (4 pulgadas) alrededor de todas las rejillas de ventilación.

△ No modificar el aparato o instalar las piezas que no sean las auténticas piezas de repuesto Wybron.

Para protegerse a sí mismo ya otros contra lesiones por caídas:

△ Cuando se cuelga el aparato sobre el nivel del suelo, verificar que la estructura pueda soportar al menos 10 veces el peso de todos los dispositivos instalados.

△ Compruebe que todos los accesorios externos y hardware de montaje estén bien fijadas y utilizar un aprobado medios de fijación secundaria como un cable de seguridad.

△ Bloquear el acceso al área de trabajo cuando se esté instalando o quitando el aparato.

Safety Notice (German Translation)

Sicherheit und Datenschutz

SAVE DIESE ANLEITUNG

LESEN und befolgen Sie alle

- ❖ Diese Anleitung Schritt-für-Schritt-Anleitungen für die Vorbereitung, Einrichtung gibt, und der Betrieb des Cygnus™ LED-Leuchte.
- ❖ Es besteht ein potentielles Risiko von Brand, Stromschlag oder Personenschäden, wenn das Produkt nicht verwendet wird, wie angewiesen.
- ❖ Die Cygnus™ ist in Innenräumen verwendet werden.

Größe und Modifikation Warnung

Wybron, Inc. Produkte entwickelt und herstellt, um den Anforderungen der Vereinigten Staaten und internationale Sicherheitsstandards erfüllen. Änderungen an den Produkten beeinträchtigen könnten Sicherheit und machen das Produkt nicht konform zu relevanten Sicherheitsstandards.

Wichtige Sicherheitshinweise

Lesen Sie dieses Handbuch vor dem Einschalten oder die Installation der Leuchte. Befolgen Sie die Vorsichtsmaßnahmen und beachten Sie alle Warnungen in diesem Handbuch und auf den Verkauf. Wenn Sie Fragen haben, wie die Leuchte sicher zu betreiben, kontaktieren Sie bitte Ihren Händler oder rufen Sie Wybron Wybron direkt an 719-548-9774 oder besuchen Sie www.wybron.com.

So schützen Sie sich und andere durch elektrischen Schlag:

WARNUNG - Dieses Gerät muss geerdet werden.

- ⚡ Schutz gegen elektrischen Schlag sichergestellt ist nur, wenn das Netzkabel angeschlossen gesetzt ist verbunden mit einer ordnungsgemäß geerdet geerdeter Steckdose.
- ⚡ Verwenden Sie eine gute Quelle der Stromversorgung, die mit örtlichen Bau-und Elektro-Codes entspricht und hat sowohl Überlast und Erdschluss.
- ⚠ Schutzart IP20. Geeignet für trockene Standorte nur. Setzen Sie das Gerät über regen oder Feuchtigkeit aus.
- ⚠ Alle Wartungsarbeiten zu einer Wybron zertifizierten Service-Techniker.

So schützen Sie sich und andere vor Verbrennungen und Feuer:

- △ Maximale Umgebungstemperatur $T_a = 40 \text{ }^\circ\text{C}$ ($104 \text{ }^\circ\text{F}$)
- △ Geben Sie einen Mindestabstand von 10 cm (4 inches) um alle Lüftungsöffnungen.
- △ Verändern Sie nicht den Verkauf oder installieren Sie alle Teile außer echten Wybron Ersatzteilen.

So schützen Sie sich und andere vor Verletzungen durch Stürze:

- △ Wenn Aussetzung der Leuchte über dem Boden, zu überprüfen, dass die Struktur können mindestens 10 mal das Gewicht aller installierten Geräte halten.
- △ Überprüfen Sie, dass alle externen Zubehör und Montagematerial sind sicher befestigt und verwenden Sie ein zugelassenes Mittel der zweiten Befestigung zB mit einem Sicherheitskabel.
- △ Block Zugang unterhalb der Arbeitsfläche, wenn die Installation oder das Entfernen der Leuchte.

Safety Notice (Swedish Translation)

SPARA DESSA ANVISNINGAR LÄS OCH FÖLJ ALLA INSTRUKTIONER

- ❖ Denna handbok ger steg-för-steg-instruktioner för beredning, installation och drift av Cygnus™ LED armatur.
- ❖ Det finns en potentiell risk för brand, elektriska stötar eller personskador om produkten inte används enligt anvisningarna.
- ❖ Den Cygnus™ skall användas i en inomhusmiljö bara.

Produkt Ändring Varning

Wybron, Inc. produkter konstrueras och tillverkas för att uppfylla kraven i USA och internationella säkerhetsnormer. Ändringar av de produkter som kan påverka säkerheten och gör produkten inte uppfyller de gällande säkerhetsnormerna.

Viktig säkerhetsinformation

Läs denna handbok innan du slår eller installera fixturen. Följ säkerhetsföreskrifterna och iaktta alla varningar i denna manual och på armaturen. Om du har frågor om hur du använder fixtur säkert, kontakta din Wybron återförsäljare eller ring Wybron direkt på 1-800-624-0146 eller gå till www.wybron.com.

För att skydda dig själv och andra från elektriska stötar:

VARNING - Denna utrustning måste JORDAS.

- ⚡ Skydd mot elolyckor endast kan uppnås om elnätet anslutna sladden är ansluten till en korrekt jordad jordade uttag.
- ⚡ Använd en bra källa till växelström som överensstämmer med lokala byggnads och elektriska koder och har både överbelastning och jordfelskydd.
- ⚠ IP20 betyg. Lämplig för torra platser. Utsätt inte fixturen för regn eller fukt.
- ⚠ Se all service till en Wybron kvalificerade servicetekniker.

För att skydda dig själv och andra från brännskador och brand:

- ⚠ Maximal omgivningstemperatur, $T_a = 40\text{ °C}$ (104 °F)
- ⚠ Ge en minsta avstånd på 10 cm (4 inches) runt alla luftventiler.
- ⚠ Modifiera inte fixtur eller installera andra delar än äkta Wybron reservdelar.

För att skydda dig själv och andra från skada till följd av fall:

- △ När upphävande av armaturen över marken, kontrollera att strukturen kan hålla minst 10 gånger vikten av alla installerade enheter.
- △ Kontrollera att alla externa tillbehör och monteringsdetaljer sitter ordentligt fast och använda en.
- △ Blockera åtkomst under arbetsområdet när du installerar eller tar bort armaturen.

Introduction

The Cygnus™ Variable White is a high performance variable white LED wash luminaire in a small, easy to integrate package. These LED fixtures deliver incredible brightness with variable color temperatures of 2800K-6000K. They use a combination of cool and warm white LEDs which achieve beautiful illumination for creating looks from natural daylight to warm hues. The LED's have a rated life span of 60,000 hours, minimizing maintenance concerns for many years.

The Cygnus Variable White uses a single DMX channel to control dimming and an optional channel to control the white color temperature. Alternately, the color temperature may be selected from a menu option.

Precision control allows for smooth subtle fades or instantaneous jumps to new intensity levels. Cygnus also has an optional "High Speed" mode that eliminates flicker on video cameras.

A grip mode menu function allows you to set the intensity and color temperature at the unit without DMX input. Once you've set the first fixture, additional daisy chained Cygnus Variable White units will automatically follow the same settings (dimmer, color temp and fan speed mode settings). The slave units will always go into Video (High Speed) mode. The units will return to grip mode with the last settings when they are powered for the next use.

Model 7520 is a 100 watt unit

Model 6520 is a 200 watt unit

Quick Start (for DMX control)

1. Connect the Equipment

- a. Connect the Cygnus to a mounting pipe with a C-clamp.
- b. Connect the safety cable to the mounting pipe.
- c. Connect the Cygnus to a DMX source with a 5-pin cable
- d. Connect to AC power (100 – 240 VAC 50/60Hz)

2. Set DMX Address to 1

- a. Press 'Menu' until the display reads 'Adr'. If 'GrP' is displayed for 1 second then the unit is in grip mode. To exit grip mode, press and hold the leftmost two buttons until 'nor' is displayed. Then repeat this step.
- b. Press 'Enter'
- c. Press the '+' or '-' keys to select '001'
- d. Press 'Enter' to save setting

3. Set Video Mode to Off

- a. Press 'Menu' until the display reads 'HSP'
- b. Press 'Enter'
- c. Press the '+' or '-' keys to select 'OFF'
- d. Press 'Enter' to save setting

4. Set Fan Speed to low

- a. Press 'Menu' until the display reads 'FAn'
- b. Press 'Enter'
- c. Press the '+' or '-' keys to select 'Lo'
- d. Press 'Enter' to save setting

5. Set The Color Temperature

- a. Press 'Menu' until the display reads 'CoL'
- b. Press 'Enter'
- c. Press the '+' or '-' keys to select 28-60 for color temps from 2800 to 6000K. The option "InP" allows the color temp to be controlled from DMX input on the 2nd channel.
- d. Press 'Enter' to save setting

Quick Start (for Grip Mode)

1. Connect the Equipment

- a. Connect the Cygnus to a mounting pipe with a C-clamp.
- b. Connect the safety cable to the mounting pipe.
- c. Connect to AC power (100 – 240 VAC 50/60Hz)
- d. Connect other slave Cygnus's by daisy chaining DMX cable starting from the first units DMX output.

2. Enter Grip Mode

- a. Press and hold the leftmost two buttons.
- b. 'GrP' will be displayed for 1 second. If 'nor' is displayed then the unit is in normal mode. If so, repeat this step.
- c. The current dimmer value will be displayed as a value 0-100.
- d. Daisy chained slave units will display 'SLA'.

3. Set the Dimmer Value

- a. Press the left set of '-' or '+' buttons to change the value.

4. Set the Color Temperature

- a. Press the right set of '-' or '+' buttons to change the value. The range is 28-60 for color temps 2800-6000K. A 'C' is displayed before the value, ex. 'C35' for 3500K.

5. Exit Grip Mode

- a. Press and hold the leftmost two buttons.
- b. 'nor' will be displayed for 1 second for normal mode.
- c. The current DMX address will be displayed.

Cygnus Operation

Selecting Normal or Grip Mode

The unit can be switched between Normal (DMX) and Grip (local) mode by holding the two leftmost buttons for 2 seconds. The display will show “nor” when normal mode is entered and “GrP” when Grip mode is entered. The meanings of the four buttons are different depending on what mode the unit is in. The Grip mode button meanings are printed above the buttons and the Normal mode meanings are printed below the buttons. Please see the User Interface picture on page 21.

Video (High Speed) Mode

The Cygnus can be used in applications where video cameras are used. In this mode the light pulses (imperceptibly) at a much higher rate. In Normal (DMX) mode, the Video (High Speed) mode is selected from the menu option labeled “HSP.” In Grip mode the unit is always in Video mode. In Video mode the fixture is not able to dim as low due to constraints of the high speed pulse rate.

Color Temperature

The user can set the color temperature of the white light from 2800K to 6000K. In Normal mode this is done through the “CoL” menu option. In Grip mode it is done by using the rightmost two buttons. The values displayed are in hundreds of degrees Kelvin and have the range 28-60. In Normal mode there is an additional setting below 28 labeled “InP” for input. When set to this value, a second DMX channel is created to control the white color temperature. DMX values in the range 0-255 create color temperatures from 2800-6000K (see Appendix A). In Grip mode a “C” is displayed in front of the two digit color temperature to distinguish it from a dimmer value.

Fan Speed

Fan speed controls the maximum light level output of the unit, which indirectly affects fan speed. Use the “Fan” menu option in Normal mode to set the speed to ‘Lo’ to achieve the quietest operation. Set it to ‘Hi’ for maximum light output. The light level output in low speed is 80% of the light output in hi speed. The Fan speed selected in Normal mode will also be used in Grip mode and automatically by any slave devices connected.

Normal (DMX) Mode

In this mode the unit is controlled with DMX. Channel 1 is the dimmer and channel 2 optionally controls the color temperature (see the section above on Color Temperature).

Grip (local) Mode

Grip mode allows the user to set a light level from the fixture without DMX. In Grip mode the light temporarily turns Video (High Speed) mode on.

Grip mode can be entered two ways. The first way is by holding down the leftmost two buttons. The display will show “GrP” for one second followed by the current dimmer value. The second way to enter Grip mode is by pressing Enter at the GrP menu.

The 4 buttons in Grip mode directly control the dimmer level and the white color temperature. When a color temperature is displayed it will have a “C” in front of it with a range of 28-60. When a dimmer level is displayed it will show the value 0-100 (percent). If the unit is power cycled when in Grip mode it will re-start Grip mode using the last settings. To exit Grip mode, press and hold the leftmost two buttons. The unit will briefly display “nor” letting you know it has returned to normal mode.

The Fan speed setting can only be changed while in Normal mode.

In Grip mode multiple units can be daisy chained together with DMX cable to make many units become slaves of one unit. The slaves will follow the dimmer, color temperature, and fan speed settings of the master unit. Slaves will also temporarily go into video mode.

While a unit is a slave it will display “SLA” and not allow any button presses. If the master unit is taken out of Grip mode then the slave units will all return to Normal mode. If a unit is in slave mode and its DMX connection to the master is lost it will exit slave mode in 5 seconds and return to its own settings. A unit cannot be put into Grip mode (as master) if it is receiving DMX, to prevent a user from accidentally making two units in a chain both masters. However, if a unit is already in Grip mode (master) and DMX is connected to it (not coming from another Cygnus master), it will temporarily leave Grip mode and follow DMX. When the DMX is removed the unit will resume Grip mode. If a unit is set to Grip master and then connected to another unit that was already in Grip master then one of the two units will exit Grip mode and become a slave.

Fixture Physical Setup

Mounting and Adjusting Fixture

Adjusting the C-clamp

- Connect a C-clamp to the yoke with the yoke bolt and washer.
- Hang C-clamp on mounting pipe and secure with the C-clamp pipe bolt.
- Connect the safety cable to the mounting pipe.
- Cygnus can be rotated to the desired position by loosening the pan screw, setting the position, and tightening the pan screw to hold the position.

Attaching Accessories to the Front Holder

Cygnus Variable White 200W can accept up to two standard 7.5” accessories. The VNS100 and MFS100 can accept one 5.75” accessory. Accessories are safely held in place with a standard spring-loaded latch.

- From the rear of the fixture, pull the accessory ring toward you.
- Load the accessory into the accessory slot in the front of the Cygnus, then release the ring.
- The plunger will return to the initial position and hold the accessory in place.

Connecting AC Power

⚠ CAUTION: Be sure the fixture is properly grounded.

Use a good source of AC power that complies with local building and electrical codes and has both overload and ground fault protection.

Input power must be 100-240VAC, 50/60Hz.

Changing the Lenses

Instructions for changing VN or MF lens assembly:

- Position the unit so the front is facing you with the filter pin on the top (12 o'clock position)
- Use a #2 phillips screwdriver to remove the seven screws from the lens assembly.
- Remove the lens assembly.
- If you are about to install the MF (24°) lens kit, then insert the 7 silver spacers onto the LED board over the seven silver stand offs that are fixed to the LED board. Insert the lens kit by lining up the assembly with the spacers.
- If you are about to install the VN (16°) lens kit, then remove the 7 silver spacers from the LED board. Insert the lens kit by lining up the assembly with the stand offs.
- Replace the screws removed in the first step. Tighten until only slightly snug. Do not over tighten.

Instructions for changing VN or MF lens kit with individual lenses and plates:

- Position the unit so the front is facing you with the filter pin on the top (12 o'clock position)
- Use a #2 phillips screwdriver to remove the seven screws from the lens face plate. This plate is the “upper” lens plate.
- Remove the upper lens plate.
- Remove the 24 or 12 lenses (200W or 100W units)
- Remove the lower lens plate. Note that there is one unique lower plate for the VN (16 deg) lenses and a different plate for the MF (24 deg) lenses and that the plates are labeled. The one upper plate is used for both lens types.
- If you are about to install the MF lenses (they do not have holes in the center of them) then first insert the 7 silver spacers onto the LED board over the seven silver hardware pieces that are fixed to the LED board.

- Or if you are about to install the VN lenses (they have holes in the center of them) then first remove the 7 silver spacers from the LED board.
- Insert the new lower lens plate for MF or VN lenses. Make sure the text on the lower plate is upright.
- Insert the lenses of type MF or VN.
- Make sure all lenses are laying flat.
- Verify that if the lower plate is labeled MF than the lenses you put in do not have holes in the center. If the lower plate is labeled VN then verify the lenses have holes in the center.
- Insert the top lens plate.
- Make sure all lenses are laying flat beneath the plate.
- Replace the screws removed in the first step. Tighten until only slightly snug. Do not over tighten.

User Interface

Controls and Indicators

Cygnus Variable White has controls and indicators as follows:

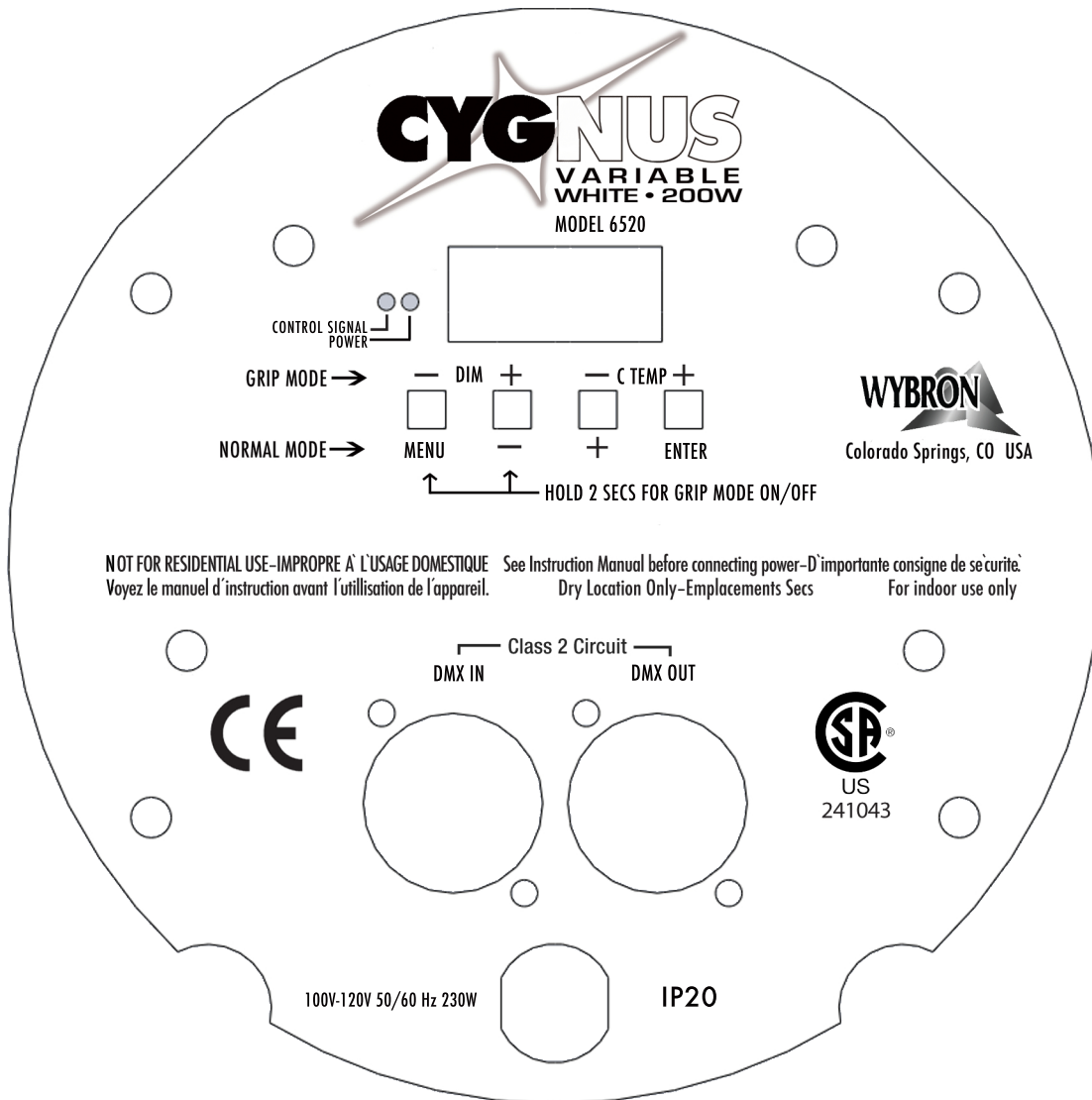

- A three-character seven-segment display
- 4 push buttons. The meaning depends on the unit being in Grip or Normal mode.
- Power (red) and DMX signal (green) indicator LEDs

The red power indicator LED remains lit when the device is powered.

The green signal indicator LED flashes when a DMX or RDM signal is present. It turns off 60 seconds after the last button press.

Selecting Normal or Grip Mode

The unit can be switched between Normal and Grip mode by holding the two leftmost buttons. The display will show “nor” when Normal mode is entered and “GrP” when Grip mode is entered. The meanings of the buttons are different for the two modes and their meaning are printed above and below the buttons.

Normal Mode

The **Menu** button allows the user to switch between menus on the menu tree.

The (+) and (-) buttons allow the user to change a selection for a single option in a menu.

The **Enter** button allows the user to enter down into a submenu to change a parameter or to accept the parameter currently displayed and return up one menu level. Changes are saved in non-volatile memory when the **Enter** button is pressed.

Grip Mode

The leftmost two buttons control the dimmer value with a range of 0-100 percent. The rightmost two buttons control the white color temperature values 28-60 for a range of 2800-6000K. When the color temperature is displayed it will be shown with a “C” in front of it to show that it is a color temperature value and not a dimmer value, ex. “C42” = 4200K.

Menu Tree (Normal Mode)

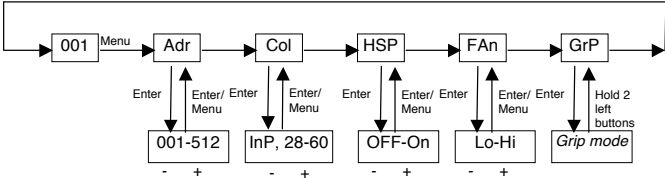

Display Messages

Menus/Values

001 – 512 The DMX addresses Cygnus will respond to.

Adr Pressing 'Enter' here will allow the current DMX address to be changed.

CoL Pressing 'Enter' here will allow the white color temperature to be changed for normal (DMX) mode. Selecting a value of "InP" will allow the color temperature to be controlled from DMX channel 2.

HSP Pressing 'Enter' here will allow the Video (High Speed) Mode to be changed.

FAn Pressing 'Enter' here will allow the fan speed mode to be changed.

GrP Pressing 'Enter' here will put the unit into Grip mode.

InP Color temperature control will be Input on DMX channel 2.

Normal Messages

nor Cygnus is in Normal (DMX) mode.

GrP Cygnus is in Grip (local) mode.

Blank Unit is running, no error conditions exist, and it has been longer than 60 seconds since the last button press.

Error Messages (Flashing)

EEP Err An attempt to write to non-volatile memory failed. The unit will continue to respond to commands.

HOT Err Here are three possible causes for this error:

- Fan failure
- Obstruction of the cooling holes in the unit
- The unit is being operated in an ambient temp above the rated 40C

SEr Err The RDM unique ID has been corrupted. The unit will operate normally but should not be used in an RDM environment. Contact the factory for assistance.

DMX Channel Assignments

Channel 1 controls Intensity (0 - 100%).

Channel 2 optionally controls Color Temperature (0-100% for 2800 - 6000K).

See Appendix A for values.

RDM Functionality

Cygnus is compliant with the RDM v1.0 standard and can be used with the Wybron InfoTrace system or other RDM systems. By definition, all required RDM parameters are supported including discovery, device info, DMX start address, identify device, etc.

Additional RDM functions supported include:

- Status and Queued messages. This allows the device to let the controller know it has something to say—like ‘my address has been changed locally’
- Device Model Description: gives the controller a human readable description of the Cygnus
- Manufacturer Label
- Device Label: user definable field up to 32 characters allowing the user to give it a meaningful name in the particular application like ‘Star curtain 2’ or ‘Shark display upper right’.
- Software version information
- DMX personality: The Cygnus personalities include selection of Fan Speed mode, color temp internal/DMX, and Video (High Speed) Mode on/off.
- DMX Start Address: This can be set remotely through an RDM system.
- Slot description: explanation of the function of each of the Cygnus’s DMX channels.
- Sensor information includes LED board temperature and white color temperature.
- Device operational hours.

Flash Reprogramming

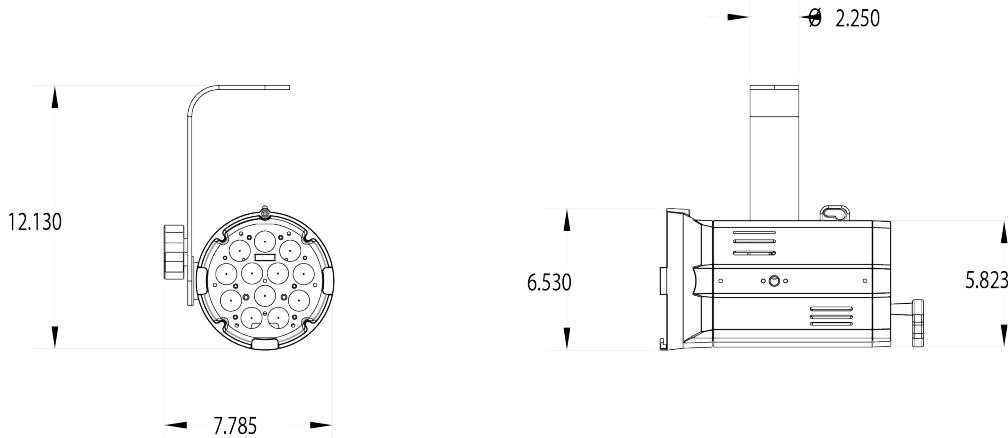
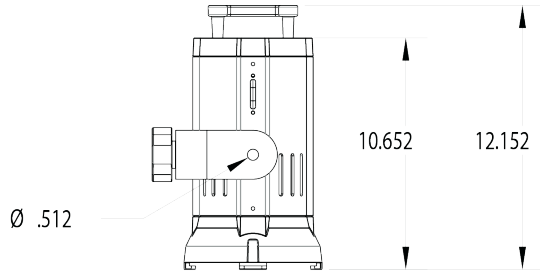

Cygnus firmware can be updated as new firmware versions become available through the DMX/RDM input connector using a Wybron InfoGate gateway and the InfoGate application. Cygnus firmware updates can be found at www.wybron.com/support/.

Specific instructions for upgrading firmware in Cygnus and other Wybron equipment can be found in the InfoGate User Manual, Firmware Upgrades section.

Cygnus Specifications

Features:

- Compact, familiar design
- Extremely smooth dimming curve

- Quad-die LED design with two cool and two warm white elements.
- In-lens white mixing
- Flicker-free on video cameras
- Integrated, self-switching power supply
- Integral safety cable mount on fixture

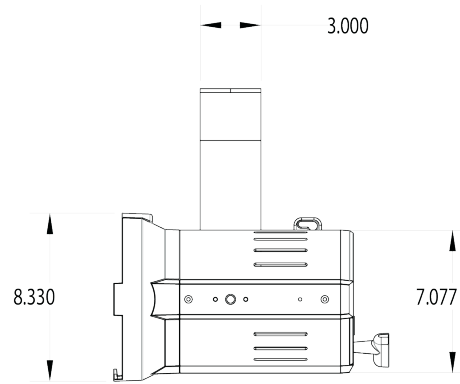
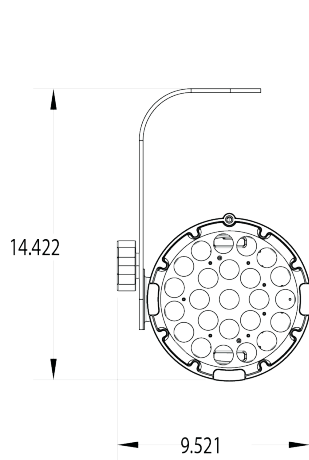
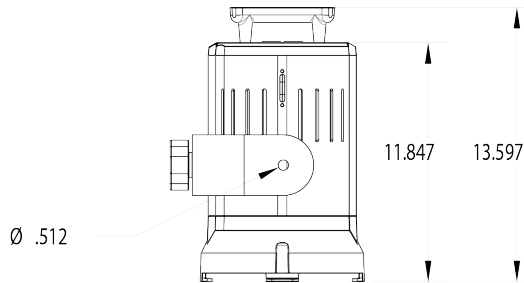

Precision

milled aluminum construction

- Standard 7.5-inch lens and accessory holder (on 200W units)
- Load-controlled low-noise fan
- Legendary Wybron Reliability
- Made in the USA
- Peak Lumens per Watt: 32

Environmental Specifications:

Maximum Ambient Temperature: 40°C / 104°F

Maximum Exterior Surface Temperature: 73°C / 163°F

Minimum Air Space Sides: 10 cm / 4"

Minimum Air Space Top: 10 cm / 4"

Minimum Air Space Rear: 10 cm / 4"

Cygnus 100W (Model 7520)

Dimensions:

Height: 6.5 in / 166 mm
Width: 7.8 in / 198 mm
Length: 12.2 in / 309 mm
Weight: 9.2 lbs / 4.2 kg

Electrical Specifications:

Power: 1A @ 100-120V ~ 50/60Hz or
1/2A @ 220-240V ~ 50/60Hz

Cygnus 200W (Model 6520)

Dimensions:

Height: 8.3 in / 212 mm
Width: 9.5 in / 242 mm
Length: 13.6 in / 345 mm
Weight: 14.5 lb / 6.6 kg

Electrical Specifications:

Power: 2A @ 100-120V ~ 50/60Hz or
1A @ 220-240V ~ 50/60Hz

Appendix A - Color Temperature Table

Color Temp (K)	DMX %	decimal
2800	0	0
2900	3	8
3000	6	16
3100	9	23
3200	12	31
3300	15	39
3400	18	47
3500	21	54
3600	24	62
3700	27	70
3800	31	78
3900	33	85
4000	36	93
4100	40	101
4200	43	109
4300	45	116
4400	49	124
4500	52	132
4600	55	140
4700	58	147
4800	61	155
4900	64	163
5000	67	171
5100	70	178
5200	73	186
5300	76	194
5400	79	202
5500	82	209
5600	85	217
5700	88	225
5800	91	233
5900	94	240
6000	97	248

Appendix B - Photometrics

Cygnus 100W



SUMMARY

Power Consumption 100 Watt
Beam / Field Angle VN 16° / 27°
 MF 24° / 42°
Peak Lumens 3256
Peak CRI 92
Hours of LED Lifespan 60,000

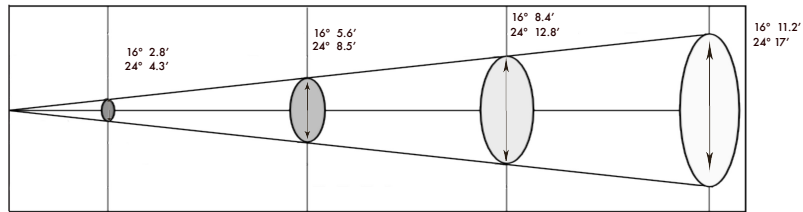

ILLUMINANCE*	10'		20'		30'		40'	
	16° fc	24° fc	16° fc	24° fc	16° fc	24° fc	16° fc	24° fc
2800K	291	115	71	30	32	14	18	8
3200K	356	154	87	39	38	18	22	11
3500K	416	201	101	51	48	24	25	14
4000K	446	217	107	56	47	26	27	15
5000K	480	234	113	58	51	28	28	16
6000K	417	203	97	49	44	24	24	14

LSD DIFFUSER COMPARISON

	No diffuser	Narrow	Medium	Wide
16° Beam / Field Angle	16° / 27°	17° / 32°	24° / 43°	34° / 58°
24° Beam / Field Angle	24° / 42°	23° / 47°	28° / 55°	37° / 65°



For lux multiply footcandles by 10.76 / For meters multiply feet by .3048

* Illuminance data measured with a Konica Minolta CL-200A Chroma Meter

Cygnus 200W



SUMMARY

Power Consumption 200 Watt
Beam / Field Angle VN 16° / 27°
 MF 24° / 42°
Peak Lumens 6512
Peak CRI 92
Hours of LED Lifespan 60,000

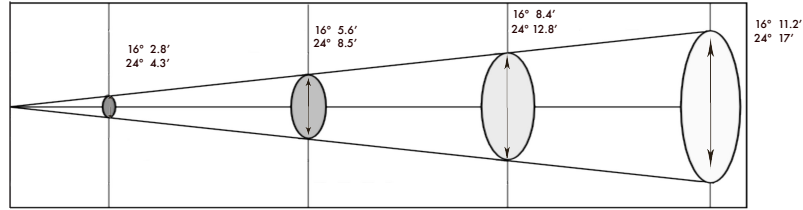

ILLUMINANCE*

Beam Angle	16°		24°		16°		24°		16°		24°	
	ft	ft	ft	ft	ft	ft	ft	ft	ft	ft	ft	
2800K	537	212	134	56	60	26	33	15				
3200K	613	265	152	70	68	33	38	19				
3500K	638	308	159	80	70	38	40	22				
4000K	667	325	166	87	73	41	42	24				
5000K	729	355	182	93	81	44	45	26				
6000K	629	307	158	80	70	38	39	22				

LSD DIFFUSER COMPARISON

	No diffuser	Narrow	Medium	Wide
16° Beam / Field Angle	16° / 27°	17° / 32°	24° / 43°	34° / 58°
24° Beam / Field Angle	24° / 42°	23° / 47°	28° / 55°	37° / 65°



For lux multiply footcandles by 10.76 / For meters multiply feet by .3048

* Illuminance data measured with a Konica Minolta CL-200A Chroma Meter

Warranty Information

WYBRON, INC. warrants to the original owner or retail customer that for a period of one year from date of delivery of a portable system or energization of a permanently installed system (up to a maximum of 18 months from delivery) its products will be free from defects in materials and workmanship under normal use and service.

Warranty does not cover any product or part of a product subject to accident, negligence, alteration, abuse, misuse or any accessories or parts not supplied by WYBRON, INC. Warranty does not cover "consumable" parts such as fuses, lamps, or color media. WYBRON, INC.'s warranty does not extend to items not manufactured by us. Freight terms on warranty repairs are FOB WYBRON, INC. factory or designated repair facility. Collect shipments or freight allowances will not be accepted.

WYBRON, INC.'s sole responsibility under this warranty shall be to repair or replace at WYBRON, INC.'s option such parts as shall be determined to be defected on WYBRON, INC.'s inspection. WYBRON, INC. will not assume any responsibility for any labor expended or materials used to repair any equipment without WYBRON, INC.'s prior written authorization. WYBRON, INC. shall not be responsible for any incidental, general or consequential damages to property, damages for loss of use, time, profits or income, or any other charges.

The owner's obligations during the warranty period under this warranty are to notify WYBRON, INC. at WYBRON, INC.'s address within one week of any suspected defect, and return the goods prepaid to WYBRON, INC. at their factory or authorized service center.

This warranty is contingent on the customer's full and timely compliance with the terms of payment set forth in said purchase order. This warranty is expressly in lieu of any and all other warranties expressed or implied including the warranties of merchantability and fitness for a particular purpose and of other obligations and liabilities on our part. The owner acknowledges that no other representations were made to him or relied upon him with respect to the quality and function of the goods sold.

This written warranty is intended as a complete and exclusive statement of the terms thereof. Prior dealings or trade usage shall not be relevant to modify, explain or vary this warranty. Acceptance of, or acquiescing in, a course of performance under this warranty shall not modify the meaning of this agreement even though either party has knowledge of the performance and a chance to object.